

Users can select and modify the following **parameters** via Domobar Junior Digital's display:

- **boiler temperature** (choosing between °C or °F)
- **coffee extraction temperature** (choosing between °C or °F)
- **steam pressure inside the boiler**

To access **the settings menu** and change the settings, follow these steps:

- 1) press the (A) button and hold for 3 seconds until the (A) and (B) buttons turn yellow
- 2) select the unit of measurement pressing the (A) and (B) buttons
- 3) confirm your selection holding the (A) button for 3 seconds and increase or decrease the value on the display using the (A) and (B) buttons

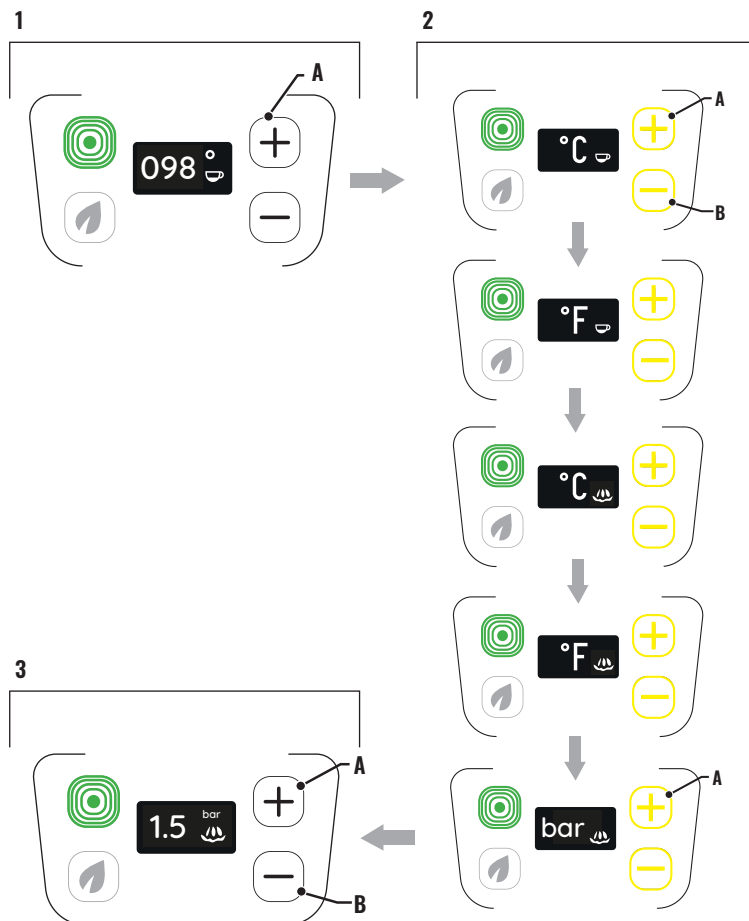

ATTENTION

The color of the LEDs (D) varies based on the pressure detected inside the boiler:

- Green: 1.4 bar – 1.1 bar (1)
- Orange: 1.1 bar – 0.7 bar (2)
- Red: less than 0.7 bar (3)

If the LED is initially green but it turns orange when the steam delivery starts, it means that the pressure has decreased under 1.1 bar.

If the user set a low pressure (0.6 bar) since the beginning, the LED will never turn green.

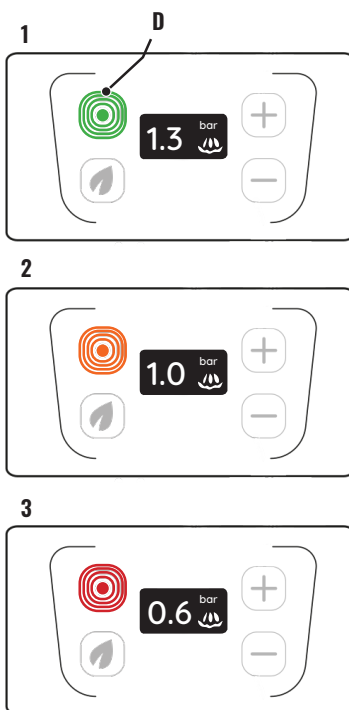

FOLLOW US



www.vbmespresso.com

Via Charles Gounod 25/27 - 20092 Cinisello Balsamo, Milan, Italy